

DRAWING FOR RE-EXCAVATION OF EXISTING POND AT CENTRAL SERICULTURE COMPLEX

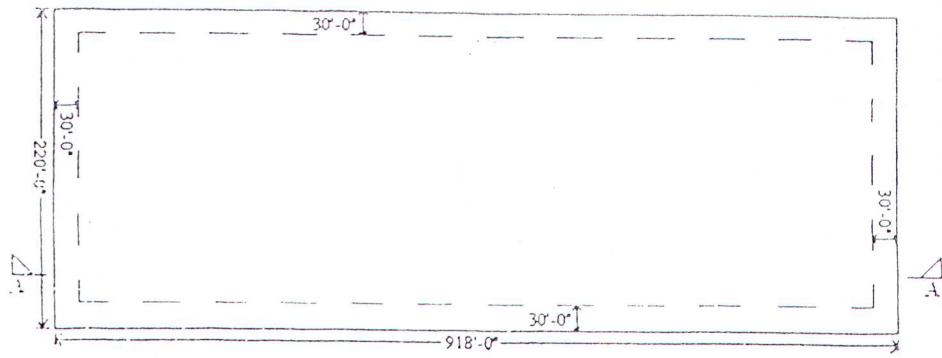

PROPOSED POND

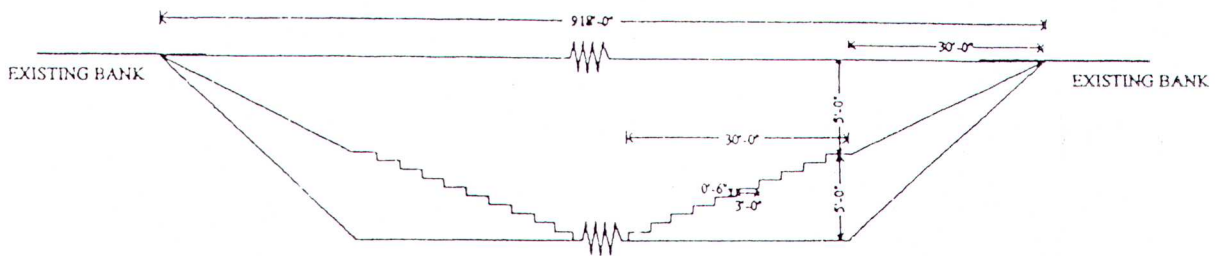

SEC - AA

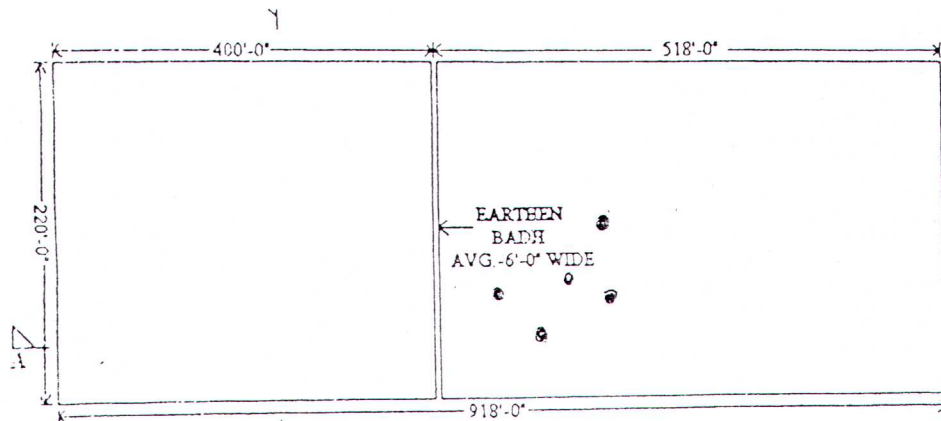

EXISTING POND

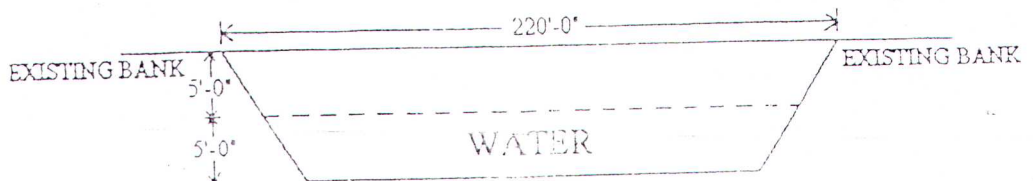

SEC - BB

U
20/12/07

Dy. Project Director
WBCADC Berhampore Project

Shattachay
20/12/07

I.T.O.(ENGG.)
BERHAMPORE C.A.
PROJECT

NOTE -- NOT TO SCALE

Shattachay 01/01/2008

Anamath Bay
14/1/2008